

FLETCHER WATER RESOURCE RECOVERY FACILITY ADMINISTRATION BUILDING RENOVATIONS - ATTACHMENT A

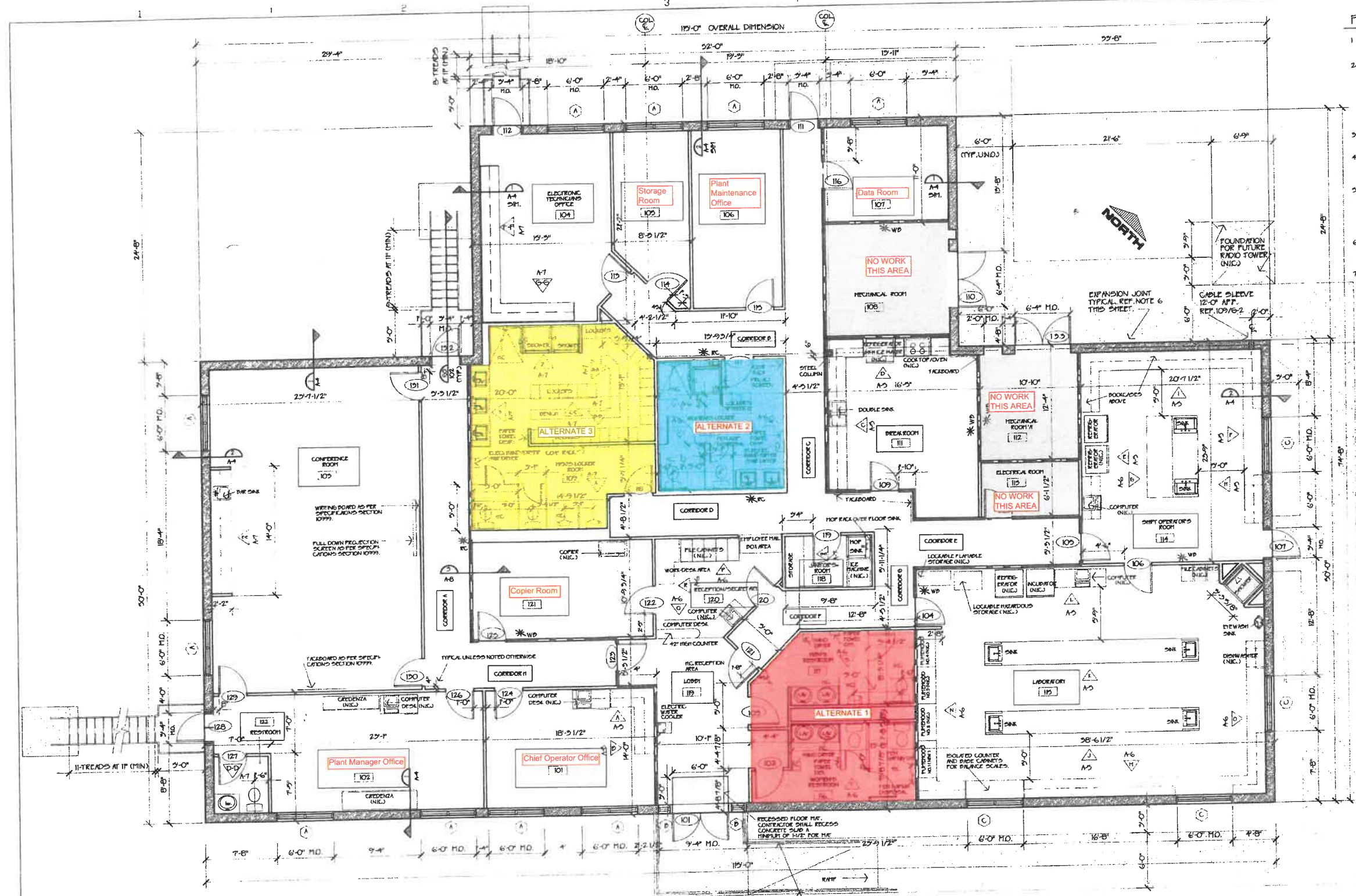

- FLOOR PLAN NOTES:**
1. DIMENSIONS ARE TO FACE OF CONCRETE MASONRY UNITS AND FACE OF METAL STUDS.
  2. INTERIOR PARTITIONS:
    - REFERENCE INTERIOR PARTITIONS DETAIL 2/A-B.
    - ALL NON-RATED PARTITIONS HEIGHTS SHALL BE 9'-0" AFF.
    - ALL OFFICE, RESTROOM, CONFERENCE ROOM, BREAKROOM, AND LOCKER ROOM INTERIOR PARTITION SHALL HAVE 5/8" PART INSULATION.
  3. FOR EXTERIOR STAIRS, LANDINGS, HANDRAILS, SIDEWALKS, ETC. REFERENCE C-1 AND G-2.
  4. FRAMED OPENINGS FOR INTERIOR DOORS ARE TO BE LOCATED 4" FROM ADJACENT (PERPENDICULAR) INTERIOR PARTITION UNO.
  5. ALL PENETRATIONS THROUGH THE HOUR FIRE RATED PARTITIONS SHALL BE FIRESTOPPED WITH UNDERWRITERS LABORATORY TESTED MATERIALS AND ASSEMBLIES. THE ASSEMBLY SHALL MAINTAIN A MINIMUM ONE-HOUR PROTECTION. REFERENCE INTERIOR PARTITION DETAIL AND NOTES SHEET A-B.
  6. MAINTAIN 1/2" EXPANSION JOINT BETWEEN EXTERIOR FACE OF BUILDING WALL AND EDGE OF CONCRETE SIDEWALK. FILL JOINT WITH FIBROUS EXPANSION MATERIAL.
  7. TS COLUMNS ARE TO BE ONE-HOUR FIRE PROTECTED WITH TWO LAYERS OF 5/8" TYPE 'X' BWP ATTACHED ALL SIDES FROM FINISHED FLOOR TO UNDERSIDE OF ROOF DECK. ASSEMBLY TO MEET REQUIREMENTS OF UL DESIGN 1026.

- LEGEND:**
- DENOTES ONE-HOUR FIRE RATED INTERIOR PARTITION WHICH SHALL EXTEND FROM FINISHED FLOOR TO UNDERSIDE OF ROOF DECK. REFERENCE DETAIL 2/A-B.
  - \* WP FIRE EXTINGUISHER MOUNTED WITH WALL BRACKET
  - \* RC FIRE EXTINGUISHER MOUNTED IN RECESSED CABINET

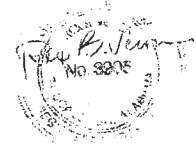

FLOOR PLAN  
SCALE: 3/16" = 1'-0"  
HANDRAILS - REF. ELEVATION 106/G-2



CHK	APVD	THIS DESIGN PREPARED BY <b>Almon Associates</b> SUBCONSULTANT 1 TO CH2M HILL	DSGN RBV DR MES CHK RBV APVD RBV	NO.	DATE	REVISION	BY	APVD
-----	------	---	---	-----	------	----------	----	------

**REUSE OF DOCUMENTS**  
THIS DOCUMENT, AND THE IDEAS AND DESIGNS INCORPORATED HEREIN, AS AN INSTRUMENT OF PROFESSIONAL SERVICE IS THE PROPERTY OF CH2M HILL AND IS NOT TO BE USED, IN WHOLE OR IN PART, FOR ANY OTHER PROJECT WITHOUT THE WRITTEN AUTHORIZATION OF CH2M HILL. HOWEVER, THIS SHALL NOT PREVENT THE REUSE OF THIS DOCUMENT BY THE CITY OF TUSCALOOSA AS PROVIDED FOR BY THE CONTRACT BETWEEN CH2M HILL AND TUSCALOOSA.

BAR IS ONE INCH ON ORIGINAL DRAWING.  
0  
IF NOT ONE INCH ON THIS SHEET, ADJUST SCALES ACCORDINGLY.

TUSCALOOSA WASTEWATER TREATMENT PLANT  
OPERATIONS BUILDING  
FOR THE  
CITY OF TUSCALOOSA  
TUSCALOOSA, ALABAMA

ARCHITECTURAL  
**FLOOR PLAN**

SHEET	A-1
DWG NO.	13
DATE	DEC. 1993
PROJ. NO.	MGM24325.H9

FLETCHER WATER RESOURCE RECOVERY FACILITY ADMINISTRATION BUILDING RENOVATIONS - ATTACHMENT A